

EN 352

M: 12g, Size: 11/S, M, L
Material: POM



TP TC 019/2011

EU type certification:

FIQH (0403), Topeliuksenkatu 41 b,
 FI-00250 Helsinki, Finland

Conformity assessment:

IFA (0121), 53757 St. Augustin, Germany
www.moldex-europe.com/conformity

Frequency [Hz]	M_f [dB]	s_f [dB]	APV_f [dB]
63	25,2	5,5	19,7
125	26,1	5,2	20,9
250	25,4	3,0	22,4
500	22,2	3,3	18,9
1000	25,2	1,8	23,4
2000	33,7	3,4	30,3
4000	40,7	3,2	37,5
8000	42,6	4,0	38,6

SNR-Value 27 [dB]

H-Value 30 [dB] • **M-Value 23** [dB] • **L-Value 22** [dB]

M_f Mean sound attenuation, s_f Standard deviation,
 APV_f Assumed protection value

MOLDEX-METRIC AG & CO. KG
www.moldex-europe.com



4 019444 007151



6825/6830

MOLDEX

40665 Rev04-19

CERTIFIED
 (EU) 2016/425
 EN 352-2:2002

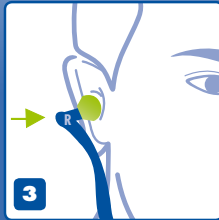
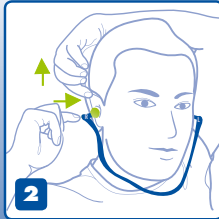
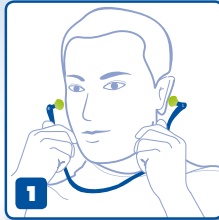

1 x



6810₀₁

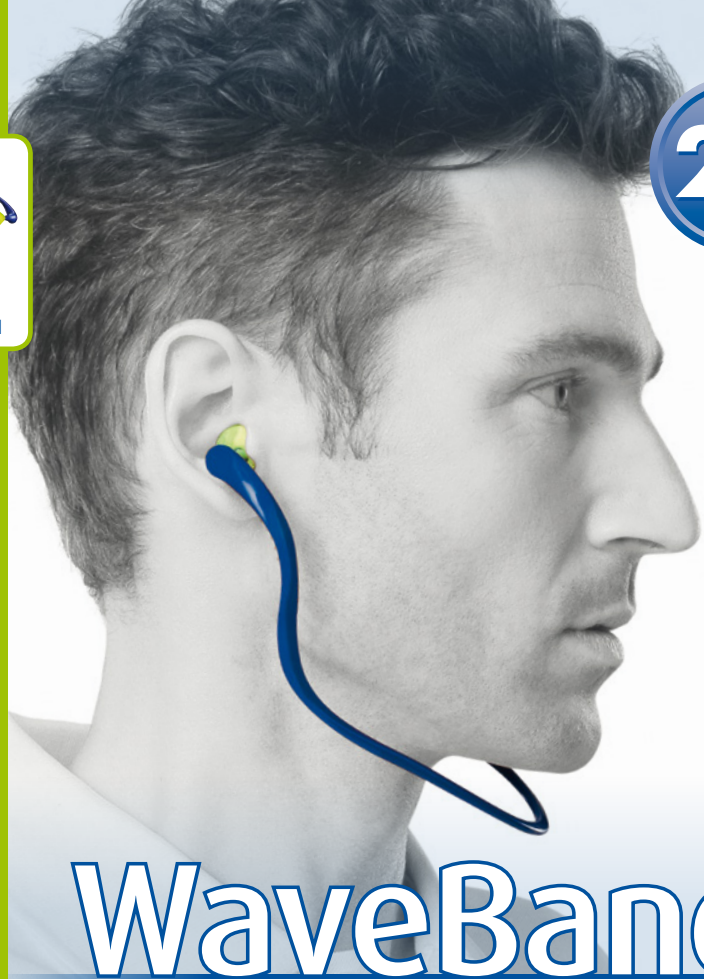

WaveBand^{1K}

made by

MOLDEX

